

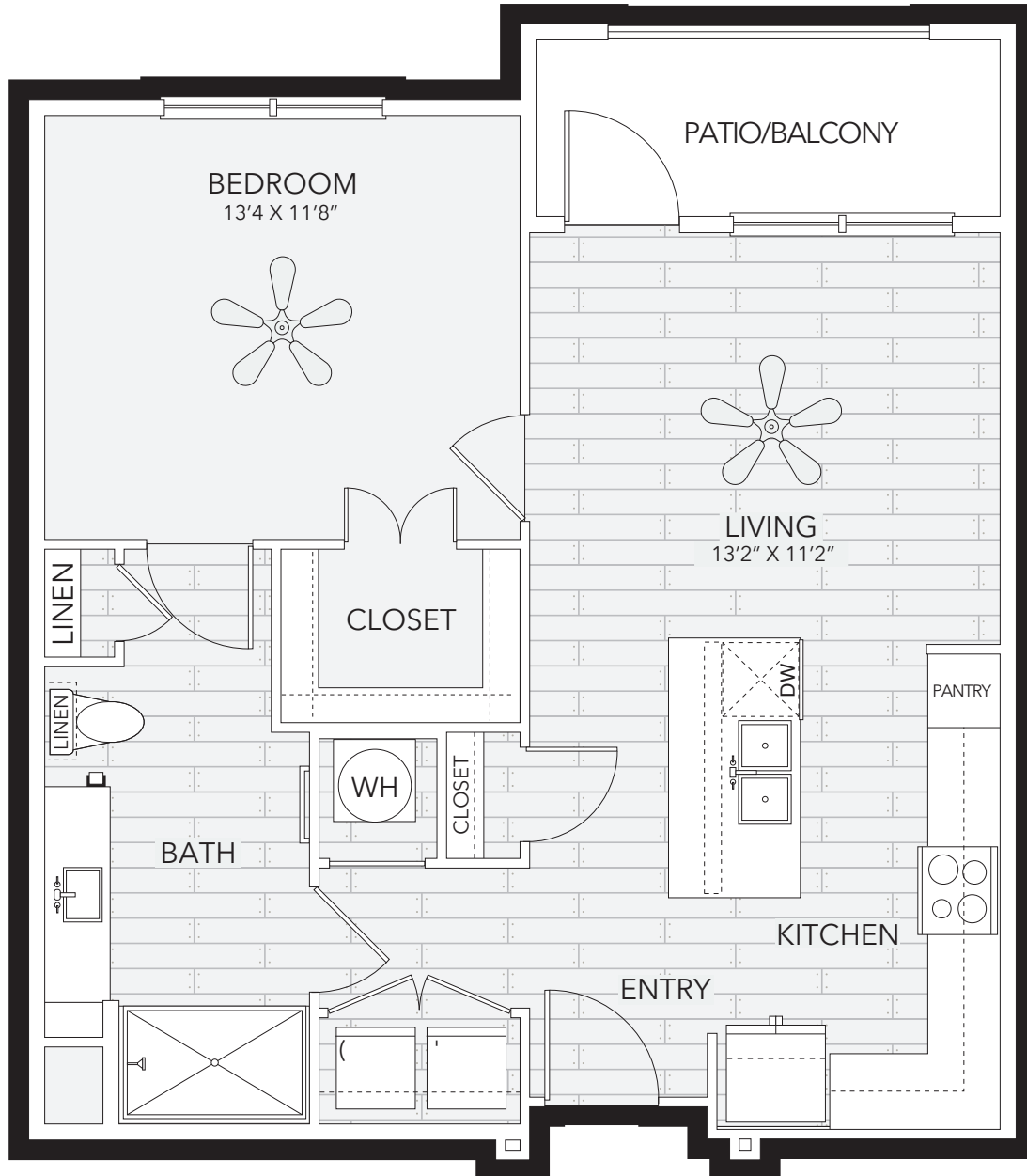

WATERMERE  
MCKINNEY

# GUADALUPE

1 BED / 1 BATH | A2 | 770 SQFT



COMMUNITY FEE: \_\_\_\_\_ MONTHLY FEE: \_\_\_\_\_

CUSTOMIZED OPTIONS: \_\_\_\_\_



(469) 915-9084 | 3351 VIRGINIA PARKWAY, MCKINNEY, TX 75072 | [WWW.WATERMEMCKINNEY.COM](http://WWW.WATERMEMCKINNEY.COM)

Integrated Senior Lifestyles (ISL) is an innovative and dynamic senior housing Management Company formed in April 2011 with the purpose of operating a comprehensive spectrum of independent, assisted living, memory care and skilled nursing communities in primary and secondary markets.